

4

3

2

1

PART NO.

REVISIONS			
LTR	DESCRIPTION	DATE	APPROVED
A	INITIAL RELEASE SEE DO 5318	C.P. 11-05-03	A.J.
B	DO 5327	C.P. 11-07-03	A.J.

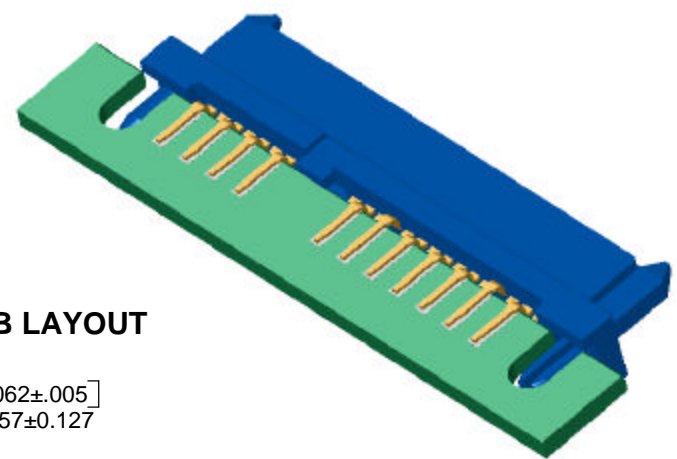
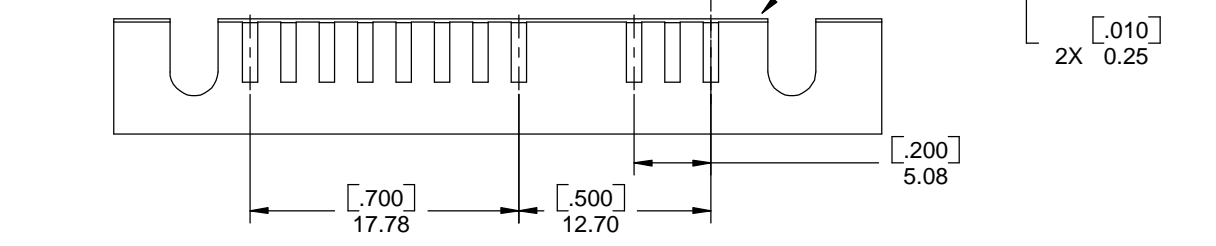
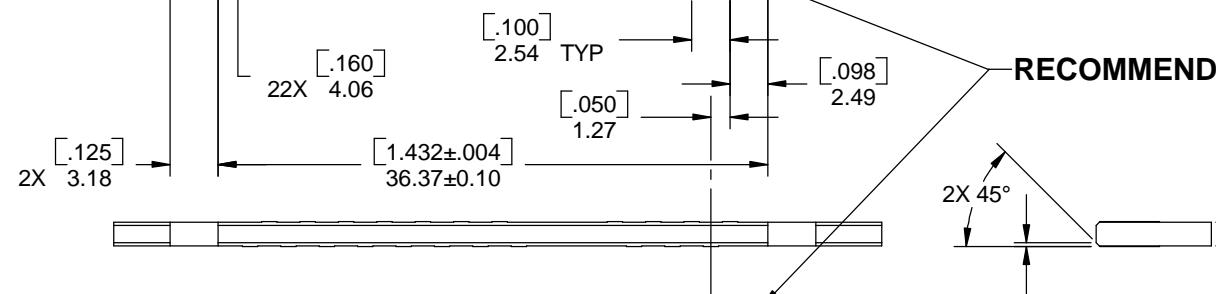
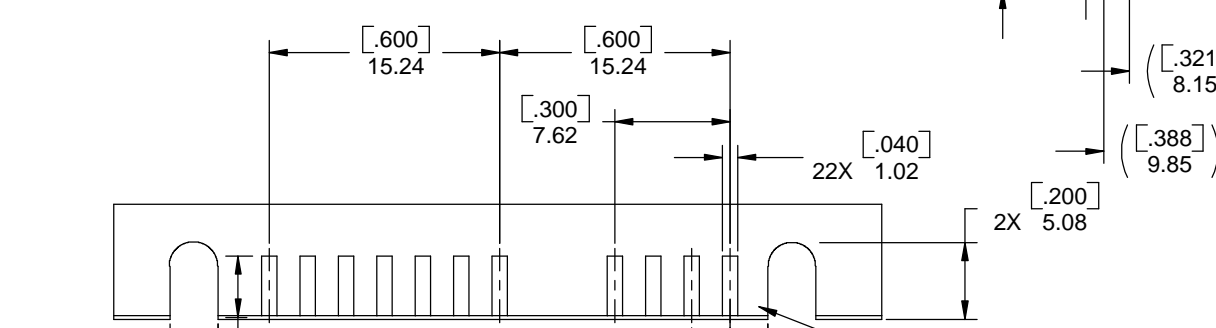
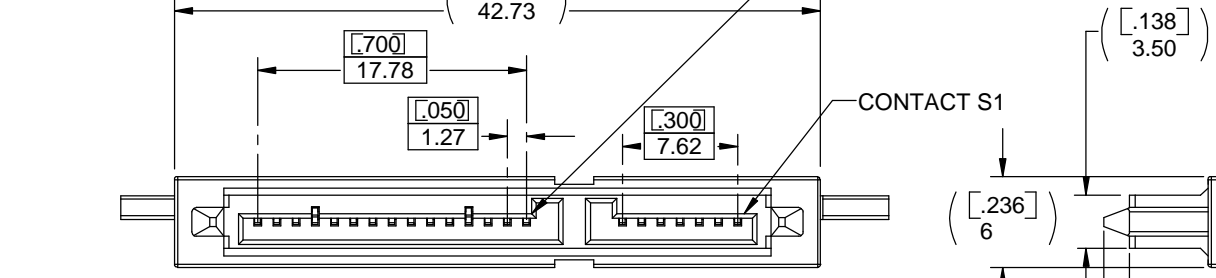
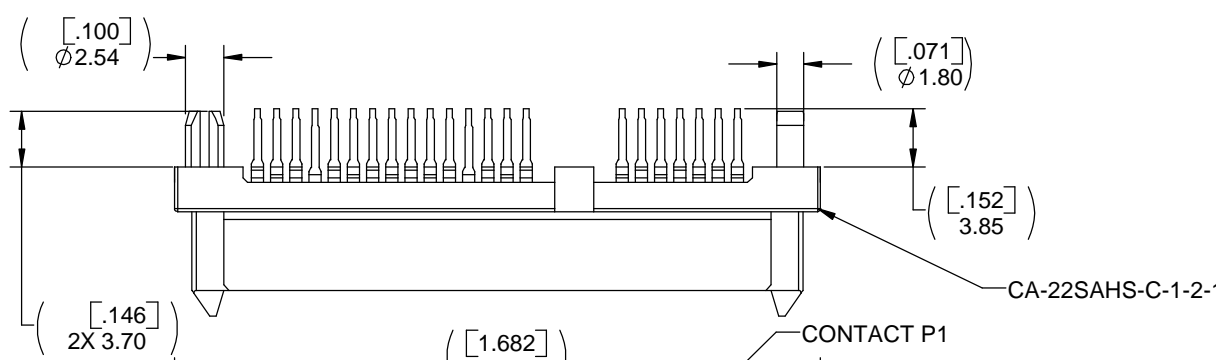

RECOMMENDED PCB LAYOUT

DIMENSIONS ARE IN INCHES
TOLERANCES ARE:
DECIMALS ANGLES
.XX ±.005 ±3°
.XXX ±.002

DIMENSIONS IN BRACKETS
[X.XX] ARE IN MILLIMETERS
TOLERANCES ARE:
DECIMALS ANGLES
X ±.13 ±3°
XX ±.05

APPROVALS	DATE
DRAWN CUONG P.	11-05-03
CHECKED A.JOCHEN	11-05-03

THE INFORMATION AND DESIGN DISCLOSED HEREIN WAS ORIGINATED BY AND IS THE PROPERTY OF CIRCUIT ASSEMBLY CORPORATION. CIRCUIT ASSEMBLY CORPORATION RESERVES ALL PATENT, PROPRIETARY, DESIGN AND SALES RIGHTS THERE TO, AND TO ANY ARTICLES DISCLOSED HEREIN EXCEPT TO THE EXTENT RIGHTS ARE EXPRESSLY GRANTED TO OTHERS. THE FOREGOING DOES NOT APPLY TO VENDOR PROPRIETARY RIGHTS.

CA CIRCUIT ASSEMBLY CORP.		18 THOMAS ST., IRVINE, CALIFORNIA 92618-2777	
CONNECTOR APPLICATION			
SAHS SERIES			
STRADDLE MOUNT			
SIZE	CODE IDENT NO.	DRAWING NO.	REV.
C	52072	630022	B
SCALE: 4 : 1		SHEET 1 OF 1	

4

3

2

1